

# Measurement Report

**PROPERTY**  
 36 Jensen Hts Pl NE, Airdrie

**CLIENT**  
 Tara Molina

**MEASUREMENT DATE**  
 February 13, 2024

**JOB #**  
 049452

Area	Methodology	Value
<b>Total Floor Area Above Grade (RMS Value)</b>	<b>RMS</b>	<b>1,469.1 ft<sup>2</sup></b>
Floor Area Main Level	RMS	1,469.1 ft <sup>2</sup>
Floor Area Below Grade (Including Basement)	Finished Area	1,252.5 ft <sup>2</sup>
Other Non-RMS Areas (e.g. Separate Structures)	Finished Area	N/A or Not Measured
Finished Area Measured	RMS + Finished Area	2,721.6 ft <sup>2</sup>

## Room Dimensions

Room	Dimensions	Level	Room	Dimensions	Level
Bedroom	10'0" x 10'6"	Main	Deck	11'10" x 6'1"	Main
Walk-in Closet	4'6" x 6'2"	Main	Entry	3'6" x 8'2"	Main
Bathroom 4P	8'8" x 8'11"	Main	Rec Room	26'0" x 13'7"	Basement
Bedroom	10'0" x 8'7"	Main	Flex Room	14'6" x 17'9"	Basement
Primary Bedroom	12'1" x 15'0"	Main	Bathroom 4P	9'1" x 4'11"	Basement
Walk-in Closet	6'1" x 5'11"	Main	Mechanical/Laundry - Unfinished	11'8" x 7'11"	Basement
Ensuite 4P	5'11" x 10'6"	Main	Bedroom	12'3" x 14'3"	Basement
Living	11'6" x 15'2"	Main	Bedroom	10'3" x 12'1"	Basement
Formal Dining	11'4" x 8'6"	Main			
Kitchen	21'6" x 13'10"	Main			
Dining	13'10" x 7'5"	Main	Attached Garage	19'3" x 21'7"	

## Bathrooms

1-Pc Bath	2-Pc Bath	3-Pc Bath	4-Pc Bath	5-Pc Bath	6-Pc Bath
			2		
1-Pc Ensuite	2-Pc Ensuite	3-Pc Ensuite	4-Pc Ensuite	5-Pc Ensuite	6-Pc Ensuite
			1		

Disclaimer: For use by real estate professionals only to assist with the sale of the property noted herein. Report provides measurements only and no evaluations of the property have been performed. Report values are based on RECA's requirements for RMS measurements and are in compliance with same (see [RECA's Guide to the RMS](#)). Said area values are derived from perimeter measurements (not individual room dimensions). Areas not allowed under RMS are excluded from the area total. Non-RMS area measurements are included only upon request and when ordered are measured with finished and unfinished space identified according to the ANSI Z765 standard. As part of your duty of care to your client and knowing this property best, please review the contents of this report carefully to confirm all areas of the property have been accounted for. REALTORS® working with buyers should verify the measurements herein before relying on them as part of an offer. Please notify us immediately of any identified discrepancies so that we may address any issues. ListSimple accepts no responsibility for any discrepancies identified more than 14 days past the report date. For full terms visit [listsimple.com/terms](https://listsimple.com/terms)

## MEASUREMENT DETAILS

Exterior Wall Approach	Exterior Wall Thickness
Detached / Semi-Detached / Townhouse	6.5 "

### RMS Areas

Level	Total Area	Exclusions	Total Exclusions	RMS Area
Main	1,469.1 ft <sup>2</sup>			1,469.1 ft <sup>2</sup>
<b>TOTAL</b>				<b>1,469.1 ft<sup>2</sup></b>

### Non-RMS Areas

Level/Space	Total Area	Unfinished Areas	Total Unfinished	Finished Area
Basement	1,359.9 ft <sup>2</sup>	Mechanical/Laundry - 107.4 ft <sup>2</sup>	107.4 ft <sup>2</sup>	1,252.5 ft <sup>2</sup>
<b>TOTAL</b>			<b>107.4 ft<sup>2</sup></b>	<b>1,252.5 ft<sup>2</sup></b>

Disclaimer: For use by real estate professionals only to assist with the sale of the property noted herein. Report provides measurements only and no evaluations of the property have been performed. Report values are based on RECA's requirements for RMS measurements and are in compliance with same (see [RECA's Guide to the RMS](#)). Said area values are derived from perimeter measurements (not individual room dimensions). Areas not allowed under RMS are excluded from the area total. Non-RMS area measurements are included only upon request and when ordered are measured with finished and unfinished space identified according to the ANSI Z765 standard. As part of your duty of care to your client and knowing this property best, please review the contents of this report carefully to confirm all areas of the property have been accounted for. REALTORS® working with buyers should verify the measurements herein before relying on them as part of an offer. Please notify us immediately of any identified discrepancies so that we may address any issues. ListSimple accepts no responsibility for any discrepancies identified more than 14 days past the report date. For full terms visit [listsimple.com/terms](https://www.listsimple.com/terms)

# SUPPORTING PLANS

Main

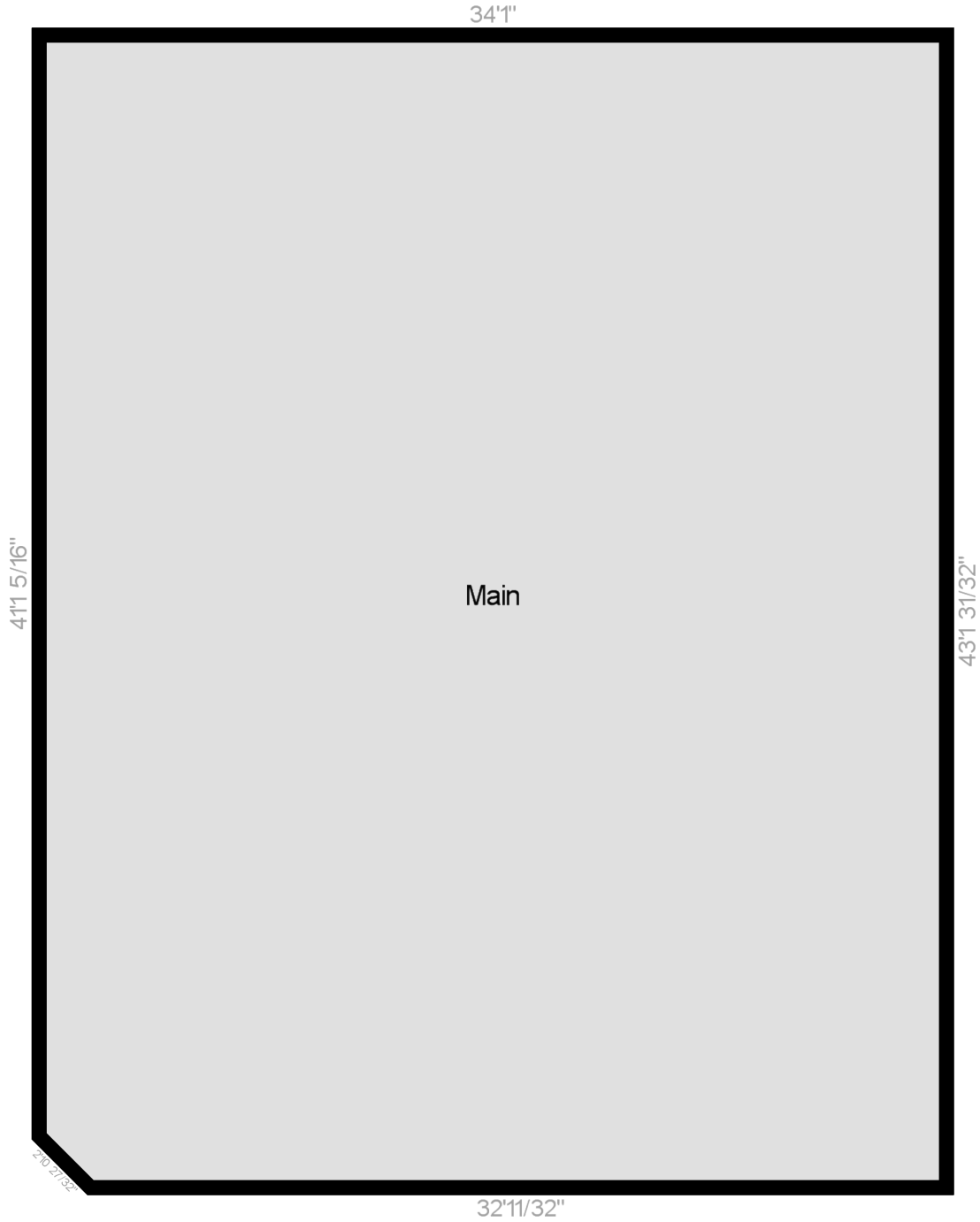

# SUPPORTING PLANS

## Basement

